

## Plastic and steel carrier rollers with belt groove

- All carrier rollers of the types KUT 300, TRK and TRM are available with grooves for round belt drives.
- **Advantages:** high transport speeds, accumulating drive, low costs, very low noise development
- Round belt drives are suitable for conveyor systems with low to medium loads.
- **Order example:** KUT 300/50/M10 RL=450 mm with one belt groove a=35  
 KUT 300/50/M10 RL=450 mm with two belt grooves a=35; a-b=30

TRM-2S 50x1.5

Standard element manufactured from polyamide

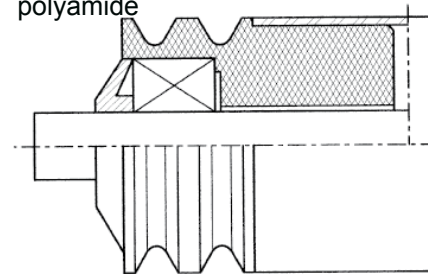

a=6    b=18    SD=40

Belt ø mm R	Tube ø mm D	Minimum mm a	Minimum mm b - a	Minimum mm b	Minimum mm SD
Steel tube					
4	40	30	30	90	32
4	50	30	30	130	40
6	50	30	30	130	38
6	60	35	35	120	48
6	80	35	35	120	68
8	88.9	35	34	120	73
Plastic tube					
5	50	30	30	80	40
5	63	35	35	80	53

## Round belt pulley

- **Material:** Delrin, ensures a quiet run and low degree of wear

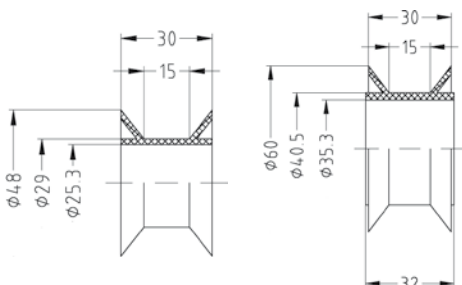

Order No.	Axle ø mm	Running surfaces ø mm	External ø mm	Width mm
Round belt pulley 29 x 25.3	25	29	48	30
Round belt pulley 40.5 x 35.3	35	40.5	60	32



**Round belts available on**